

Boinka Store 1920's



After church at Boinka



Danyo Store and Post Office



Pritchard Family & wheat stack



Danyo School

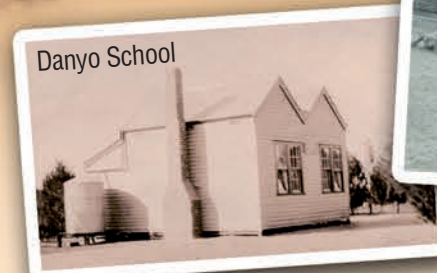

Opening of Beasley's Bore, Boinka c1920

BOINKA

Town blocks went up for sale in the new town of Boinka on the 2nd July 1912. Prices at Boinka went a lot higher than the blocks at Murrayville & Kow Plains. The average price per block at Boinka was £48.15 the first premises appeared during 1912.

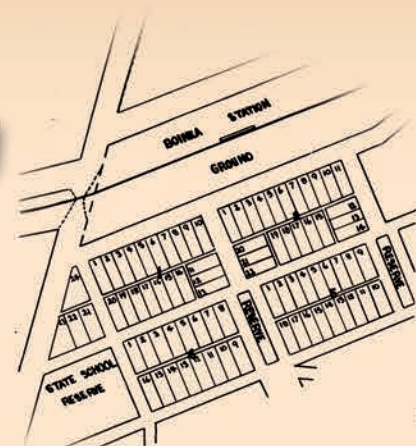

TOWNSHIPS OF THE PAST

Boinka, Danyo, Linga & Tutye were established in 1911-12 in the area which had been leased by Dugald Macpherson and where Kow Plains had been the head station for the area. All towns were established parallel to the railway line. The towns had all been surveyed with areas allocated for schools, reserves and in most cases cemeteries, it was envisaged that they would progress and serve the community for many years. The town's peaked in the 1930's then gradually declined. The last two General stores to close were Cowangie and Boinka in 1976.

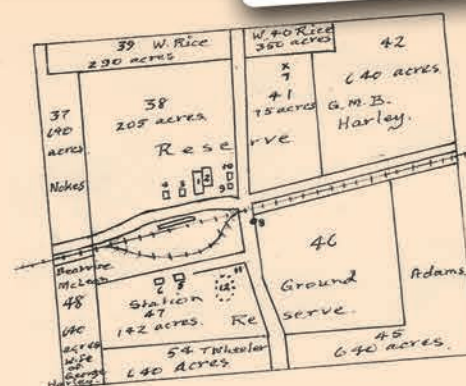

DANYO

No map appears to be available for the Danyo Township, however a sketch map has been provided by Mr. Lindsay Harley.



Linga Township

LINGA

At its peak Linga boasted a General Store, Billiard Saloon & Coffee Palace, Post Office, Telephone exchange & Commonwealth Bank Agency.

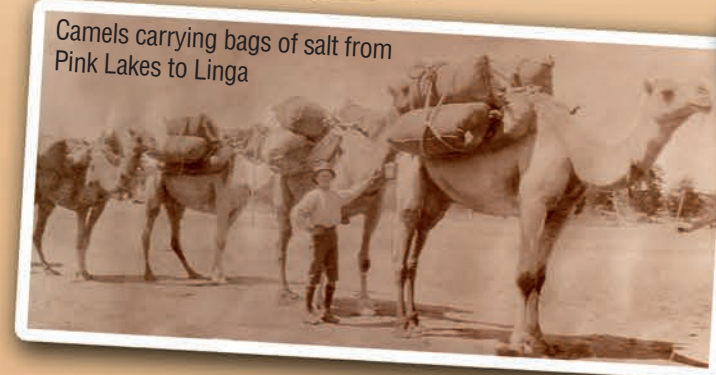
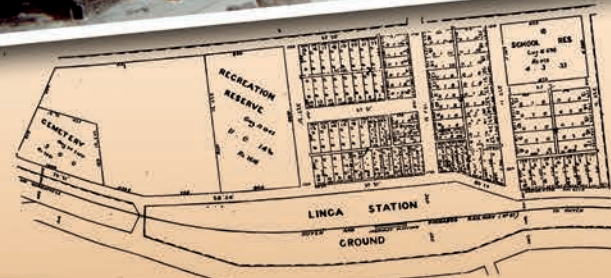

Camels carrying bags of salt from Pink Lakes to Linga



Mr Barell the Bootmaker

TUTYE

At its peak Tutye had a General Store, Post Office, Bank, Blacksmith Shop, Boot & Shoe Repairers & Grocery Shop.

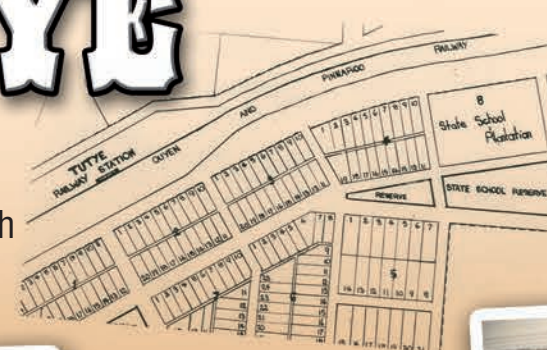

Tutye Township

Rear of Boseley's General Store



Linga Store



Co-operative Farmer's Store c.1930

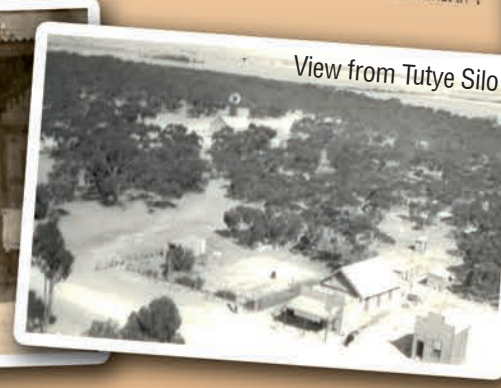

View from Tutye Silo



Boseley's General Store, Tutye 1950's